

Air
Air



Hot water
Eau chaude



Grease
Graisse



High pressure water
Eau à haute pression



Oil
Huile de lubrification



DIESEL

Fields of application



Refueling
Revitaillements



Aeronautics
Aéronautiques



Military
Militaire



Nautical
Navigation



Mines
Mines



Construction
Bâtiment



Agriculture
Agriculture



Chemical
Chimie



Auto repair
Réparation de voiture



Industry
Industrie



Car wash
Lave-auto



Industrial cleaning
Nettoyage industriel



Food industry
Industrie alimentaire



Big kitchens
Grandes cuisines

SERIE 8400



- Brackets in steel, painted with epoxy resin powders.
- Standard joint

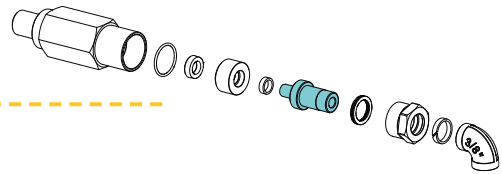

- End pipe fitting in brass/steel
- Screws and bolts in steel

SERIE 8400 LIGHT STAINLESS STEEL

NEW



- Bracket in stainless steel AISI 304
- Standard joint

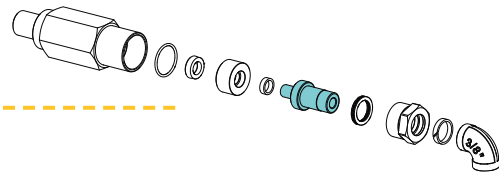

- End pipe fitting in brass/steel
- Screws and bolts in stainless steel

SERIE 8400 FULL STAINLESS STEEL

NEW



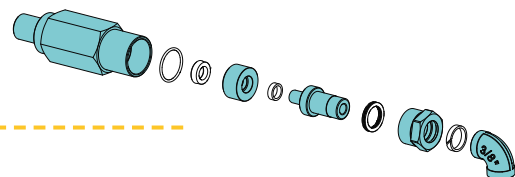

- Bracket in stainless steel AISI 304
- Rotating joint and incoming fitting in stainless steel

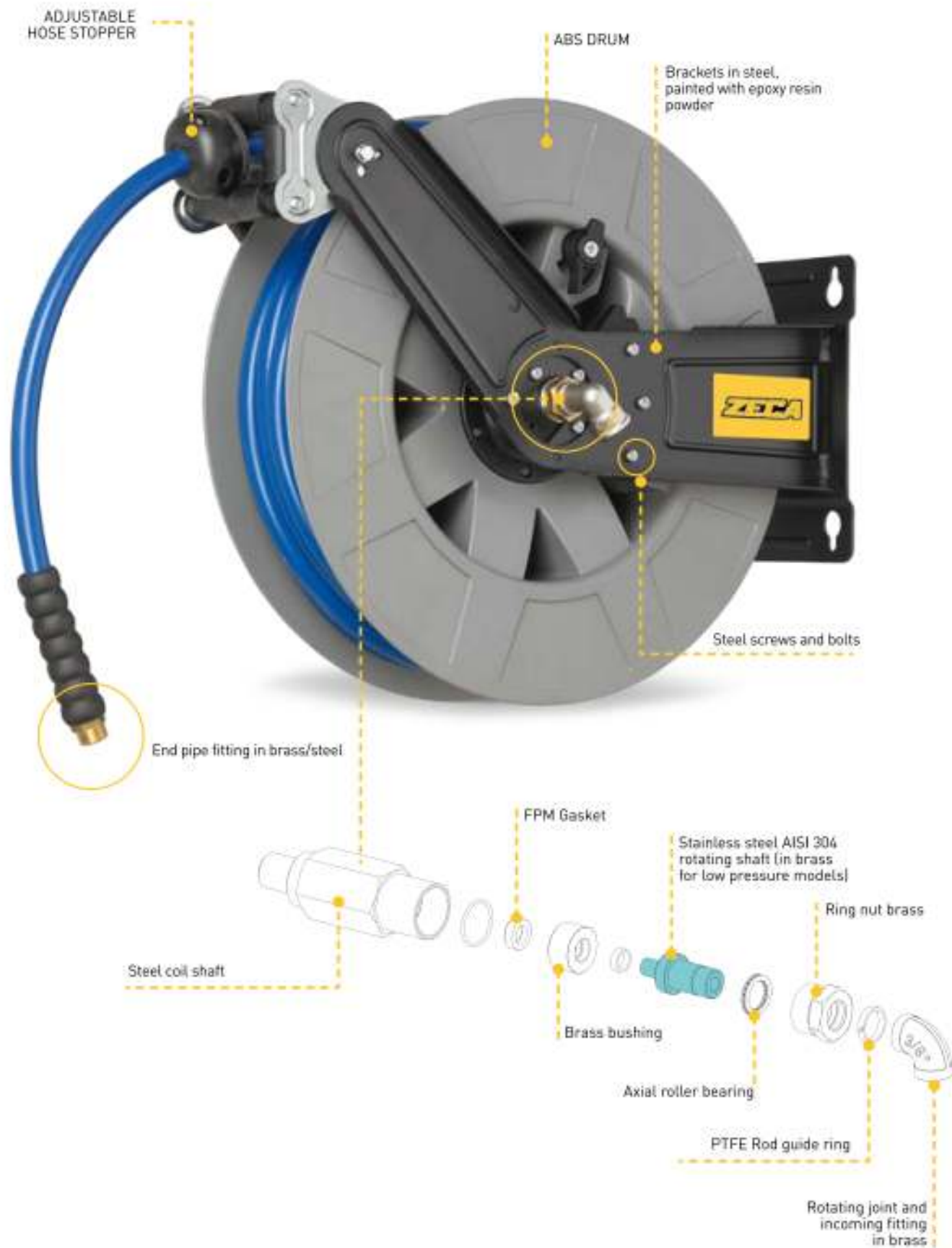

- End pipe fitting in stainless steel
- Screws and bolts in stainless steel



  <p>Compliance with Directive 2014/34/EU Marking: CE Ⓜ B 2 GB e IIB T4/T135° C X Type Examination Certificate Number IMQ 14 ATEX 009 X Compliance with: EN 13443-1; 2009 EN 13443-5; 2011</p>	<p>ISO EN 12100</p>   <p>2006/42/CE</p>	 <p>14</p>	<p>mm 550x505x270 Kg 10</p>
			

	Hose Type	Hose Ø (mm)	Hose length (m)	Art.		Fluid temperature	End pipe fitting	Incoming fitting		
AIR - WATER 20 bar	No hose	/	/	8401	/	-15°C/+50°C	1/2" F	1/2" F		
		/	/	8480	AISI 316L joint					
	SAE 100R6	6 mm (1/4")	20	8412	/				-15°C/+50°C	1/4" M
		8 mm (5/16")	20	8402	/					3/8" M
		10 mm (3/8")	12	8404	/					1/2" M
			18	8406						3/8" M
		12,5 mm (1/2")	10	8408	/					1/2" M
			15	8410						3/8" M
	KPU	10 mm (3/8")	20	8424	/		1/2" M			
		12,5 mm (1/2")	15	8426			3/8" M			
20			8427	1/2" M						
WATER 15 bar	PU - FOOD QUALITY*	12,5 mm (1/2")	12	8432	/	-10°C/+60°C	1/2" M	1/2" F		
DIESEL - OIL 15 bar	PVC - PU	19 mm (3/4")	8	8415	/	-1 °C/+60°C	3/4" F swivelling	3/4" M		
AD BLUE 15 bar	PVC - PU	19 mm (3/4")	8	8482	AISI 316L joint	-10°C/+60°C	3/4" F swivelling	3/4" M		
OIL 160 bar	EN 857 1SC	12,5 mm (1/2")	10	8474	/	-15°C/+120°C	1/2" F swivelling	3/8" F		
OIL - WATER 200 bar	No hose	/	/	8440	/	-15°C/+130°C	1/2" F			
	EN 857 1SC Black	8 mm (5/16")	20	8441	/				3/8" F swivelling	
		10 mm (3/8")	15	8442	/					
			18	8443						
	EN 857 1SC Blue Non Marking	10 mm (3/8")	15	8446	/					
			18	8448						
OIL - GREASE 400 bar	No hose	/	/	8460	/	-20°C/+120°C		1/2" F		
	EN857 2SC	6 mm (1/4")	12	8462	/		3/8" F			
			18	8463	/		1/4" M			

*** EN**

NOTE: REG. UE 1935/2004 AND REG. UE 10/2011 certified hose for use in the food industry. Not suitable for food liquids transfer.

FR

NOTE: REG. UE 1935/2004 AND REG. UE 10/2011 Tuyau certifié pour utilisation dans l'industrie alimentaire. Ne convient pas au passage des liquides alimentaires.

DE

NOTE: REG. UE 1935/2004 AND REG. UE 10/2011 Zertifizierter Schlauch für den Einsatz in der Lebensmittelindustrie. Nicht für Lebensmittelflüssigkeiten geeignet.

ES

NOTE: REG. UE 1935/2004 AND REG. UE 10/2011 Manguera certificada para uso en la industria alimentaria. No apto para líquidos alimenticios

NEW MODEL
LIGHT STAINLESS STEEL

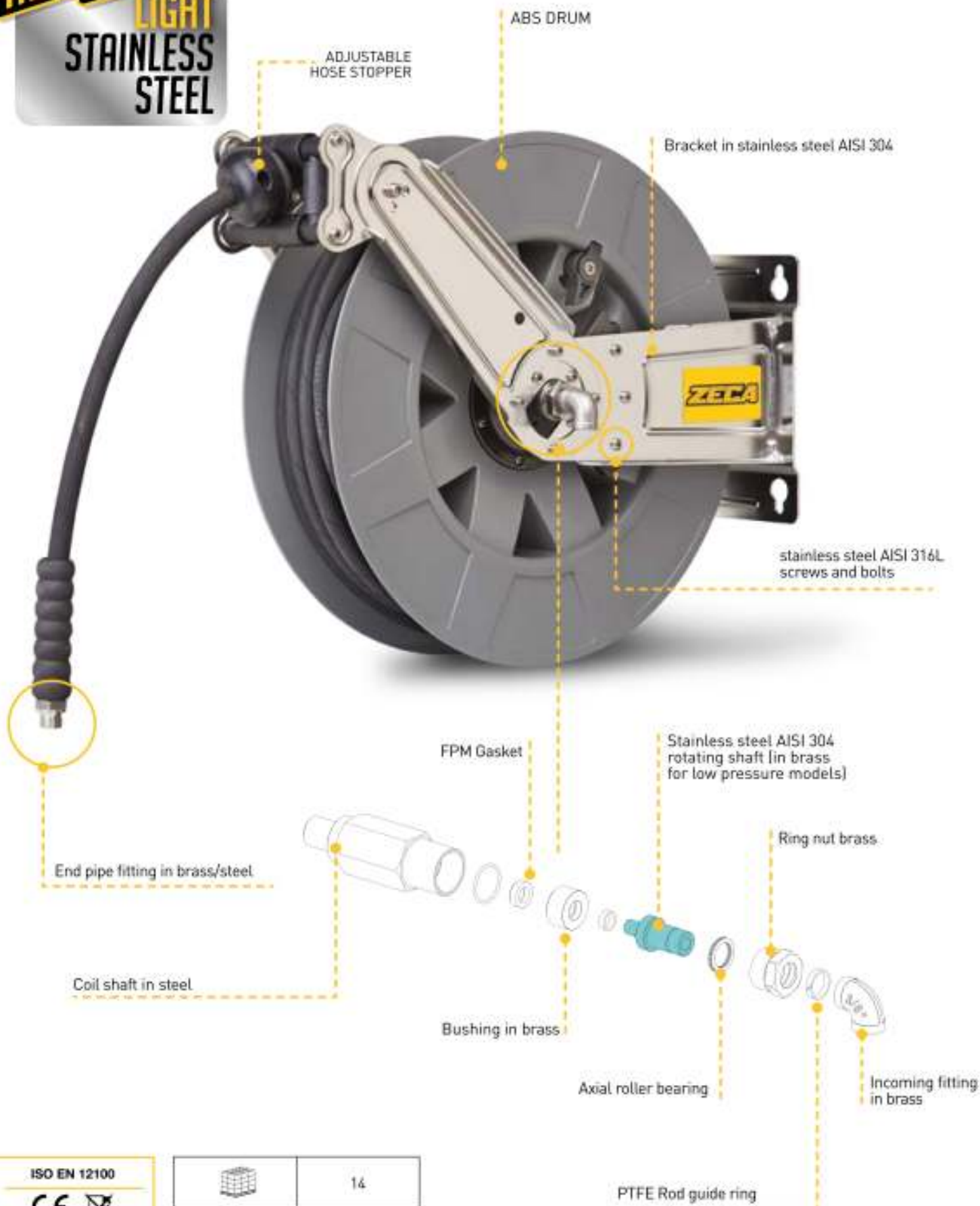

ISO EN 12100
CE
2006/42/CE

	14
	mm 550x505x270 Kg 10

EN Technical Features

The Light Stainless Steel hose reels are perfect to a variety of applications, from the food and drink industry to the boating industry and the chemical sector, heavy duty work environments with corrosive atmosphere. They are the ideal for industrial cleaning, blowing operations and transports of fluids such as oil.

FR Caracteristiques techniques

Les enrouleurs Light INOX conviennent à une large gamme d'applications, du secteur alimentaire à la navigation et à la chimie, aux environnements de travail agressifs et avec atmosphères corrosives. Idéal pour le nettoyage industriel, le soufflage et le transport de liquides tels que l'huile.

DE Technische Merkmale

Die Schlauchaufroller Light INOX eignen sich für verschiedene Anwendungsbereiche, vom Lebensmittelbereich über den maritimen und chemischen Bereich bis hin zu aggressiven Arbeitsumgebungen und korrosiven Atmosphären. Ideal für die industrielle Reinigung, das Blasen und den Transport von Flüssigkeiten wie Öl.

ES Caracteristicas tecnicas

El enrollador Light INOX es idóneo para aplicaciones diversas, en el sector alimentario, náutico, químico, en ambientes de trabajo agresivos y con atmósferas corrosivas. Ideal para limpiezas industriales, operaciones de soplado y transporte de fluidos como aceite.

	Hose Type	Hose Ø (mm)	Hose length (m)	Art.	Fluid temperature	End pipe fitting	Incoming fitting
AIR - WATER 20 bar	No hose	/	/	8401/1003	-15°C/+50°C	1/2" F	1/2" F
	SAE 100R6	10 mm (3/8")	12	8404/1000		3/8" M	
			18	8406/1000			
	KPU	12,5 mm (1/2")	15	8426/1002		1/2" M	
			20	8427/1002			
WATER 15 bar	PU - FOOD QUALITY*	12,5 mm (1/2")	12	8432/1001	-10°C/+60°C	1/2" M	1/2" F
OIL - WATER 200 bar	No hose	/	/	8440/1003	-15°C/+130°C	1/2" F	3/8" F swivelling
	EN857 1 SC Black	10 mm (3/8")	15	8442/1000			
			18	8443/1000			
			15	8446/1000			
	EN 857 1SC Blue Non Marking		18	8448/1000			

* **EN**
NOTE: REG. UE 1935/2004 AND REG. UE 10/2011 certified hose for use in the food industry. Not suitable for food liquids transfer.

FR
NOTE: REG. UE 1935/2004 AND REG. UE 10/2011 Tuyau certifié pour utilisation dans l'industrie alimentaire. Ne convient pas au passage des liquides alimentaires.

DE
NOTE: REG. UE 1935/2004 AND REG. UE 10/2011 Zertifizierter Schlauch für den Einsatz in der Lebensmittelindustrie. Nicht für Lebensmittelflüssigkeiten geeignet.

ES
NOTE: REG. UE 1935/2004 AND REG. UE 10/2011 Manguera certificada para uso en la industria alimentaria. No apto para líquidos alimenticios

NEW MODEL
FULL STAINLESS STEEL

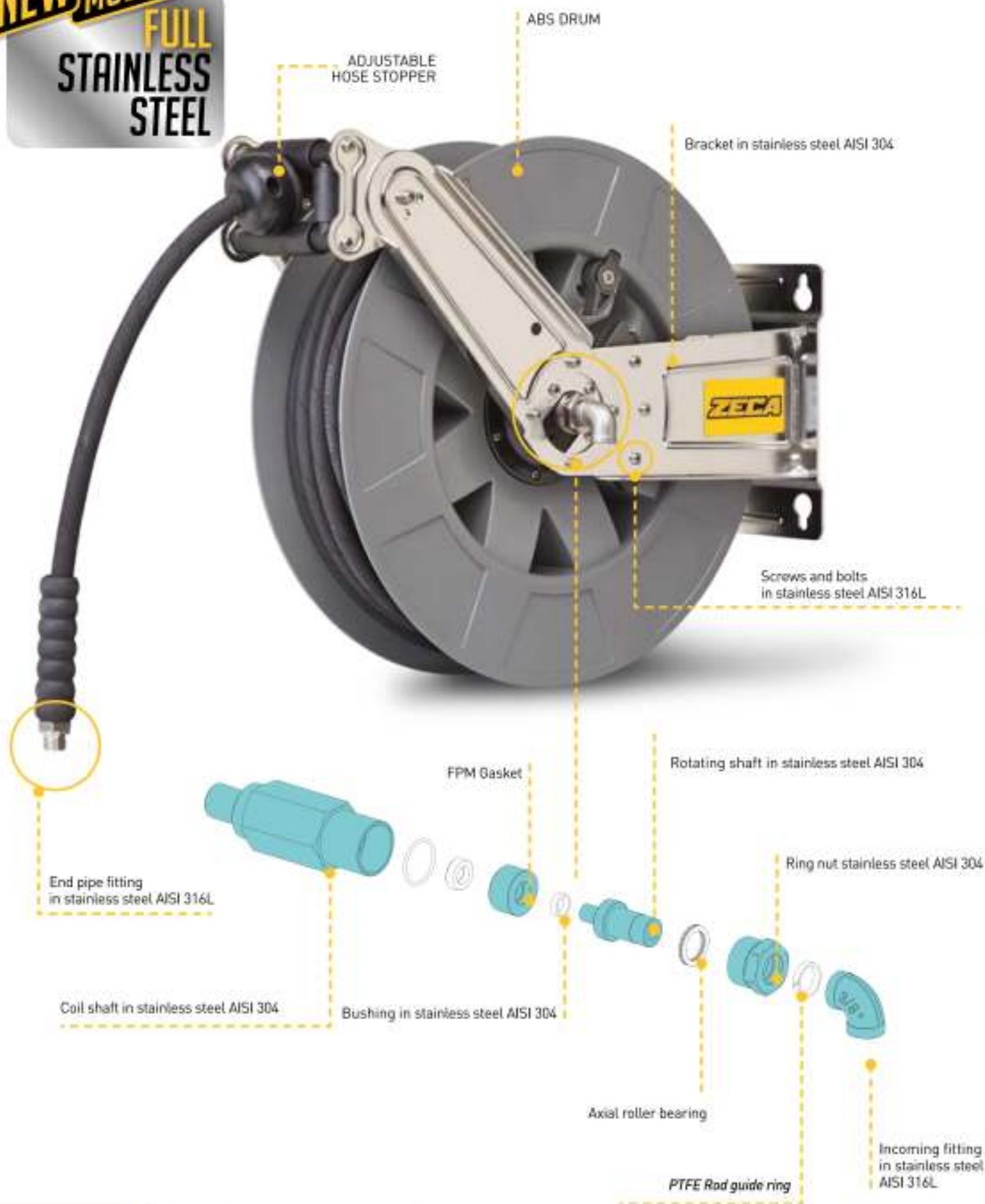

ISO EN 12100
CE RoHS
2006/42/CE

	14
	mm 550x505x270 Kg 10

EN Technical Features

The Full Stainless Steel are the ideal for transport of fluids such as oil, AdBlue, air and water, for industrial cleaning and blowing operations. They are perfect for different applications: food and drink industry, boating industry, chemical sector, heavy duty work environments and corrosive atmosphere.

FR Caracteristiques techniques

Les enrouleurs FULL INOX sont convenables pour le transport de liquides tels que huile, AdBlue, air et eau, pour le nettoyage industriel et le soufflage. Ils conviennent à différentes applications: secteur alimentaire, la navigation, la chimie, les environnements de travail agressifs et atmosphères corrosives.

DE Technische Merkmale

Die Schlauchaufroller Full INOX eignen sich für verschiedene Anwendungsbereiche, vom Lebensmittelbereich über den maritimen und chemischen Bereich bis hin zu aggressiven Arbeitsumgebungen und korrosiven Atmosphären. Ideal für die industrielle Reinigung, das Blasen und den Transport von Flüssigkeiten wie Öl und AdBlue.

ES Caracteristicas tecnicas

El enrollador Full INOX es ideal para transporte de fluidos como aceite, AdBlue, aire y agua, para limpiezas industriales y operaciones de soplado. Es idóneo para aplicaciones diversas: el sector alimentario, náutico, químico, en ambientes de trabajo agresivos y con atmósferas corrosivas.

	Hose Type	Hose Ø (mm)	Hose length (m)	Art.	Fluid temperature	End pipe fitting	Incoming fitting
AIR - WATER 20 bar	No hose	/	/	8401/1113	-15°C/+50°C	1/2" F	1/2" F
	SAE 100R6	10 mm (3/8")	12	8404/1111		3/8" M	
			18	8406/1111			
	KPU	12,5 mm (1/2")	15	8426/1111		1/2" M	
			20	8427/1111			
WATER 15 bar	PU - FOOD QUALITY*	12,5 mm (1/2")	12	8432/1111	-10°C/+60°C		1/2" F
ADBLUE 15 bar	PVC -PU	19 mm (3/4")	8	8482/1111	-10°C/+60°C	3/4" F swivelling	3/4" M
OIL - WATER 200 bar	No hose	/	/	8440/1113	-15°C/+130°C	1/2" F	3/8" F
	EN857 1 SC Black	10 mm	15	8442/1111		3/8" F swivelling	
			18	8443/1111			
	EN 857 1SC Blue Non Marking	(3/8")	15	8446/1111			
			18	8448/1111			

* **EN**
NOTE: REG. UE 1935/2004 AND REG. UE 10/2011 certified hose for use in the food industry. Not suitable for food liquids transfer.

FR
NOTE: REG. UE 1935/2004 AND REG. UE 10/2011 Tuyau certifié pour utilisation dans l'industrie alimentaire. Ne convient pas au passage des liquides alimentaires.

DE
NOTE: REG. UE 1935/2004 AND REG. UE 10/2011 Zertifizierter Schlauch für den Einsatz in der Lebensmittelindustrie. Nicht für Lebensmittelflüssigkeiten geeignet.

ES
NOTE: REG. UE 1935/2004 AND REG. UE 10/2011 Manguera certificada para uso en la industria alimentaria. No apto para líquidos alimenticios

COIL COVER



Art. 8400/CY

Yellow coil cover
Couvercle de bobine jaune
Gelbe Spulenabdeckung
Cubierta de bobina amarilla



Art. 8400/CB

Black coil cover
Couvercle de bobine noir
Schwarze Spulenabdeckung
Cubierta de la bobina negra

SWIVEL BRACKET



Art. 8400/SW

Swivel bracket
Support réglable
Verstellbare Halterung
Soporte ajustable



Art. 8400/SWI

Stainless steel swivel bracket
Support orientable en acier inoxydable
Verstellbare Halterung aus Edelstahl
Soporte oscilante de acero inoxidable

Optional serie 8400

ART. 8400/SL Inlet hose 60 cm - 20 bar - 1/2" SAE 100 R6 - fittings 1/2" M and 1/2" F rotating
Tuyau d'entrée 60 cm - 20 bar - 1/2" SAE 100 R6 - raccords 1/2" M e 1/2" F tournant

ART. 8400/SK Inlet hose 60 cm - 20 bar - 1/2" KPU - fittings 1/2" M and 1/2" F rotating
Tuyau d'entrée 60cm - 20 bar - 1/2" KPU - raccords 1/2" M e 1/2" F tournant

ART. 8400/SH Inlet hose 60 cm - 200 bar - 3/8" 1SC black - fittings 3/8" M and 3/8" F rotating
Tuyau d'entrée 60 cm - 200 bar - 3/8" 1SC noir - raccords 3/8" M e 3/8" F tournant

Possible installation

WALL INSTALLATION

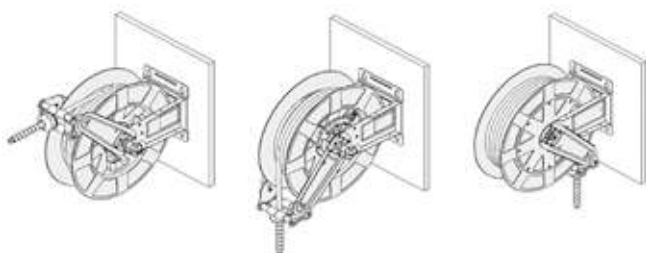

CEILING INSTALLATION

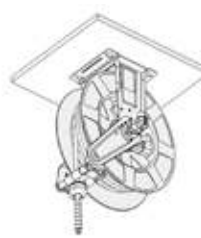

BENCH INSTALLATION

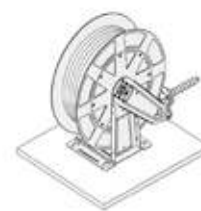

Dimensions

