

## Series **F3100/FF3600**

### • Industrial Fire Protection

#### To handle 3/4" through 1-1/2" I.D. booster hose or 1" through 1-3/4" I.D. collapsible hose.

- The reel can be installed on the floor or wall.
- Steel construction is standard. Aluminum or stainless steel construction is available.
- Choose disc rewind or removable direct crank rewind.
- Supplied with spring actuated pin lock.
- Standard inlet, outlet riser, and hub assembly are steel (also available in stainless steel).
- Rollers and roller mounting brackets are accessory items. Specify roller position.

#### Series **F3100**

- Standard inlet: 1" 90° ball bearing swivel joint with 1" female NPT threads.
- Standard outlet: 1" male NST threads (1.375" x 8 threads per inch).
- Pressures to 1000 psi (69 bar).
- Temperatures from -40° F to +400° F (-40° C to +204° C).

#### Series **FF3600**

- Standard inlet: 1-1/2" 90° ball bearing swivel joint with 1-1/2" female NPT threads and 2" Victaulic® groove.
- Standard outlet: 1-1/2" male NST threads (1.990" x 9 threads per inch).
- Pressures to 600 psi (41 bar).
- Temperatures from -20° F to +212° F (-29° C to +100° C).

#### Both Series

- Consult factory for other sizes and/or threads.
- Consult factory for other pressures and temperatures.
- Removable crank rewind is standard.
- For hand over hand rewind option (less crank), consult factory.

**CAUTION:** When using Niedner|Altra® hose, a special riser and/or larger drum diameter is required (consult factory). See page 18.



**F3100 Series**  
Standard configuration shown



**FF3600 Series**  
Standard configuration shown

# Series F3100/FF3600

• Industrial Fire Protection

## PARTS DRAWING – F3100 – ISO 113; FF3600 – ISO 111

Model Number	Hose Capacity of Reel feet m				Approx. Weight Crank Rewind lb. kg		Reel Dimensions*** in. mm						
	Round Hose		Collapsible Hose		NET	SHIP	A	B	E	F	G	H	X
	I.D. in. mm	3/4 19	1 25	1 26									
	O.D. in. mm	1-9/32 33	1-1/2 38	1/2 x 1-3/4 13 x 44									
<b>F3116-25-26</b>		<b>100</b> 30	<b>75</b> 23	<b>200</b> 61	<b>85</b> 39	<b>120</b> 54	<b>13</b> 330	<b>7.5</b> 191	<b>24.75</b> 629	<b>25.5</b> 648	<b>27.88</b> 708	<b>15.5</b> 394	<b>7.75</b> 197
<b>F3120-25-26</b>		<b>150</b> 46	<b>100</b> 30	<b>350</b> 107	<b>94</b> 43	<b>129</b> 59	<b>17</b> 432	<b>11.5</b> 292	<b>24.75</b> 629	<b>29.5</b> 749	<b>27.88</b> 708	<b>15.5</b> 394	<b>9</b> 229
<b>F3124-25-26</b>		<b>200</b> 61	<b>125</b> 38	<b>450</b> 137	<b>103</b> 47	<b>138</b> 63	<b>21</b> 533	<b>15.5</b> 394	<b>24.75</b> 629	<b>33.5</b> 851	<b>27.88</b> 708	<b>15.5</b> 394	<b>13</b> 330
<b>F3128-25-26</b>		<b>275</b> 84	<b>175</b> 53	<b>650</b> 198	<b>113</b> 51	<b>155</b> 70	<b>25.5</b> 648	<b>20</b> 508	<b>24.75</b> 629	<b>37</b> 940	<b>27.88</b> 708	<b>15.5</b> 394	<b>17.5</b> 445
<b>F3124-30-31</b>		<b>350</b> 107	<b>250</b> 76	–	<b>103</b> 47	<b>153</b> 70	<b>21</b> 533	<b>15.5</b> 394	<b>28.75</b> 730	<b>33.5</b> 851	<b>29.88</b> 759	<b>15.5</b> 394	<b>13</b> 330
<b>F3130-30-31</b>		–	<b>300</b> 91	–	<b>113</b> 51	<b>143</b> 65	<b>27.5</b> 699	<b>22</b> 559	<b>28.75</b> 730	<b>40</b> 1016	<b>29.88</b> 759	<b>15.5</b> 394	<b>19.5</b> 495

Model Number	Hose Capacity of Reel feet m				Approx. Weight Crank Rewind lb. kg		Reel Dimensions*** in. mm								
	Round Hose		Collapsible Hose		NET	SHIP	A	B	D	E	F	G	H	X	Y
	I.D. in. mm	1-1/2 38	1-1/2 38	1-3/4 44											
	O.D. in. mm	2-1/16 52	3/4 x 3 19 x 76	7/8 x 3-1/4 22 x 83											
<b>FF3620-25-26</b>		<b>75</b> 23	<b>150</b> 46	<b>75</b> 23	<b>104</b> 47	<b>139</b> 63	<b>17</b> 432	<b>11.5</b> 292	<b>25.5</b> 648	<b>24.75</b> 629	<b>30.75</b> 781	<b>27.88</b> 708	<b>15.5</b> 394	<b>9</b> 229	<b>21.75</b> 552
<b>FF3624-25-26</b>		<b>75</b> 23	<b>150</b> 46	<b>100</b> 30	<b>113</b> 51	<b>148</b> 67	<b>21</b> 533	<b>15.5</b> 394	<b>25.5</b> 648	<b>24.75</b> 629	<b>34.75</b> 883	<b>27.88</b> 708	<b>15.5</b> 394	<b>13</b> 330	<b>21.75</b> 552
<b>FF3628-25-26</b>		<b>100</b> 30	<b>200</b> 61	<b>150</b> 46	<b>123</b> 56	<b>173</b> 78	<b>25.5</b> 648	<b>20</b> 508	<b>25.5</b> 648	<b>24.75</b> 629	<b>39.25</b> 997	<b>27.88</b> 708	<b>15.5</b> 394	<b>17.5</b> 445	<b>21.75</b> 552
<b>FF3624-30-31</b>		<b>100</b> 30	<b>250</b> 76	<b>150</b> 46	<b>124</b> 56	<b>174</b> 79	<b>21</b> 533	<b>15.5</b> 394	<b>25.5</b> 648	<b>28.75</b> 730	<b>34.75</b> 883	<b>30.38</b> 772	<b>15.5</b> 394	<b>13</b> 330	<b>21.75</b> 552
<b>FF3628-30-31</b>		<b>150</b> 46	<b>300</b> 91	<b>250</b> 76	<b>134</b> 61	<b>184</b> 83	<b>25.5</b> 648	<b>20</b> 508	<b>25.5</b> 648	<b>28.75</b> 730	<b>39.25</b> 997	<b>30.38</b> 772	<b>15.5</b> 394	<b>17.5</b> 445	<b>21.75</b> 552
<b>FF3634-30-31</b>		<b>200</b> 61	<b>400</b> 122	<b>350</b> 107	<b>147</b> 67	<b>197</b> 89	<b>31.5</b> 800	<b>26</b> 660	<b>25.5</b> 648	<b>28.75</b> 730	<b>45.25</b> 1149	<b>30.38</b> 772	<b>15.5</b> 394	<b>23.5</b> 597	<b>21.75</b> 552
<b>FF3630-33-34</b>		<b>250</b> 76	<b>450</b> 137	<b>350</b> 107	<b>138</b> 63	<b>188</b> 85	<b>27</b> 686	<b>22</b> 559	<b>31.5</b> 800	<b>31.75</b> 806	<b>41.25</b> 1048	<b>32.38</b> 822	<b>16.5</b> 419	<b>19.5</b> 495	<b>27.75</b> 705

**Notes:**

- Specifications subject to change.
- Upon request, reels can be supplied with drum lengths other than shown and with disc sizes in other diameters.
- Power rewind is not available on these models. See Series F or FF.
4. 4" clearance needed for crank handle removal.
5. **Be sure to check dimensions and weights prior to ordering.**

**NOTICE:** A flexible connector must be used between the inlet pipe and the inlet swivel joint.

\*\*\*X, Y indicate mounting holes.

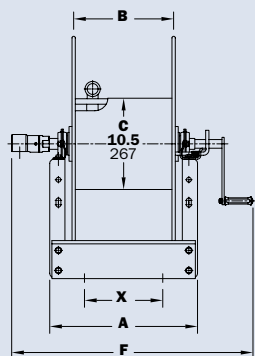

F3100

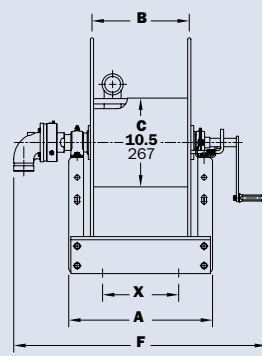
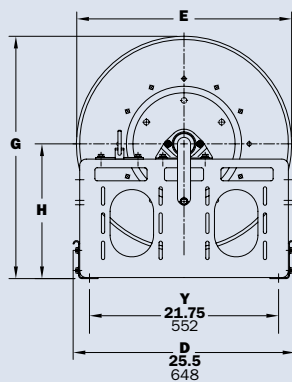

FF3600